

File best viewed when downloaded



CENTURY

LIGHTING | ART | DESIGN

joe kraus lighting

301-537-5808

joe@joe kraus lighting.com

www.joe kraus lighting.com

DoubleTree Philadelphia











1 CHANDELIER (CH-03) - CONCEPT
5401 SCALE: NTS

*DETAILS OF BOLTS & FASTNERS

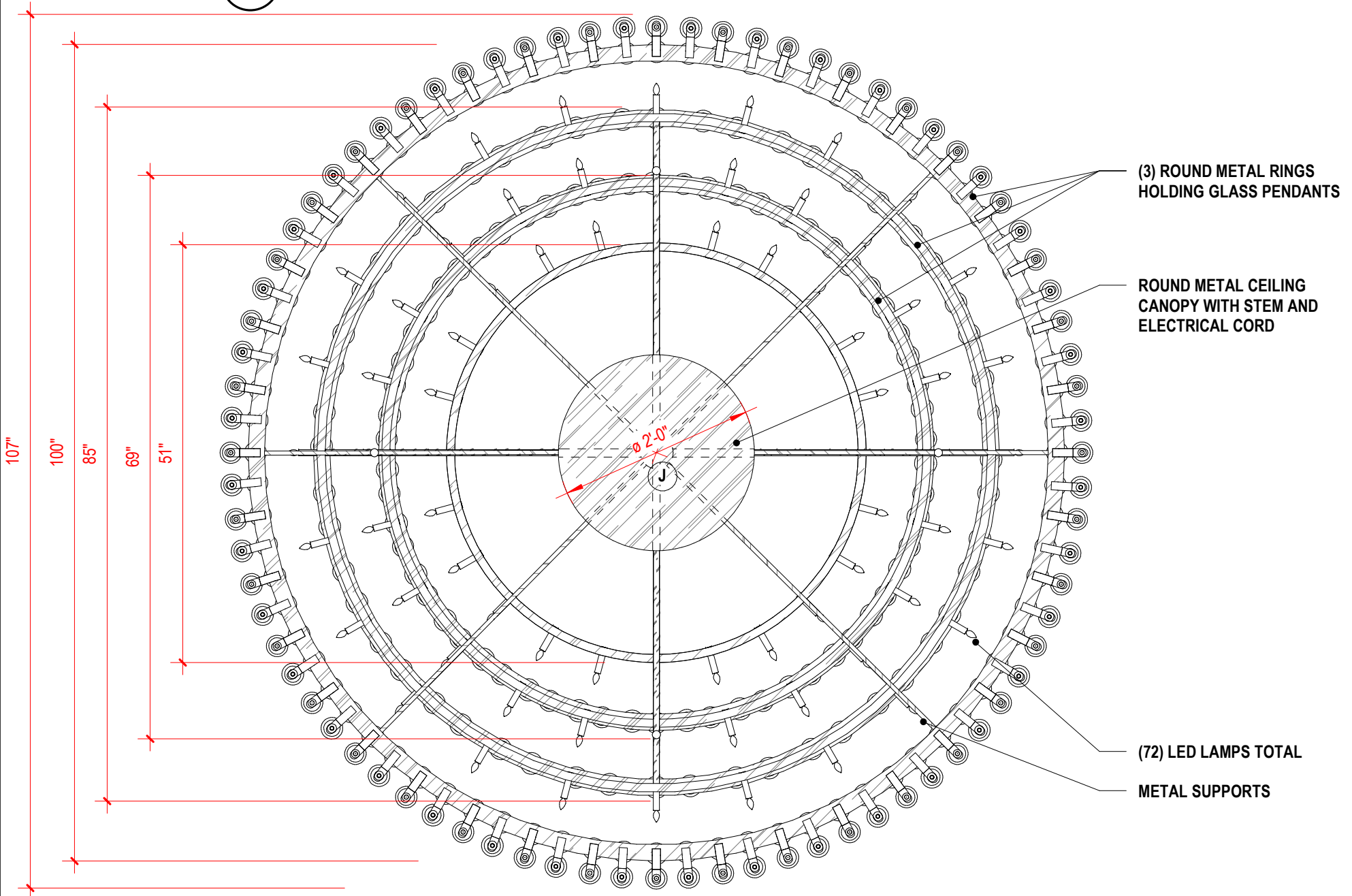

2 CHANDELIER (CH-03) - PLAN
5401 SCALE: 3/4" = 1'-0"

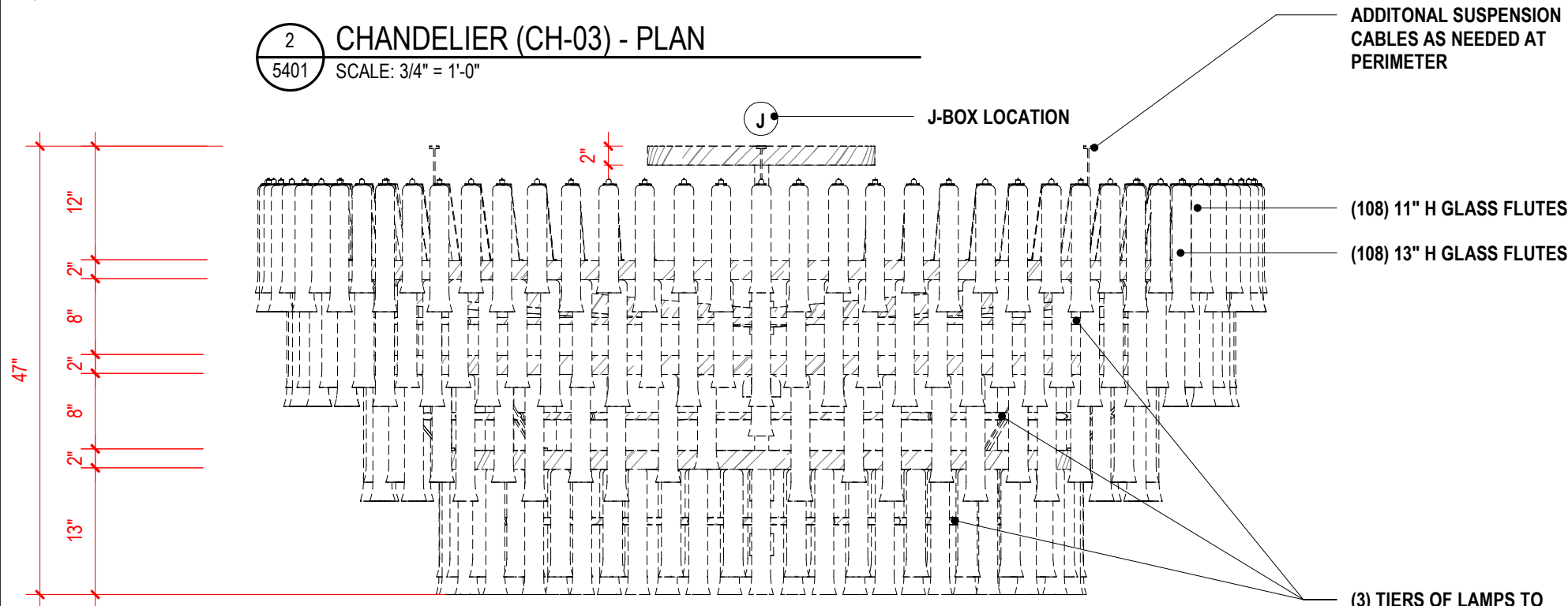

3 CHANDELIER (CH-03) - FRONT
5401 SCALE: 3/4" = 1'-0"

SCALE: As indicated	QUANTITY: 3	<div>RD · JONES</div> <div>INTERIOR ARCHITECTURE, DESIGN, AND PROCUREMENT</div> <div>729 E. PRATT STREET, STE 2000, BALTIMORE, MD 21202</div> <div>TEL: 410.332.4700 FAX: 410.332.4701</div> <div>www.RDJONES.com</div>	FINISH NOTES: METAL: Painted Metal to look like Aged Brass - to match designer's sample GLASS: Clear Vertical Ribbed Glass	
ISSUE DATE: 04/29/2025	PAGE 1 OF 2			
REVISION 1:	PROJECT NO.: 3508			
REVISION 2:	PROJECT NAME: DOUBLETREE - CENTER CITY		Lamping: (72) 5W E12 Candelabra LED, 120V, 2700K - Vendor to Provide	
REVISION 3:	LOCATION: PHILADELPHIA, PA		DRAWING TITLE: Chandelier at Ormandy Ballroom - Level 1	SPEC #: 5401

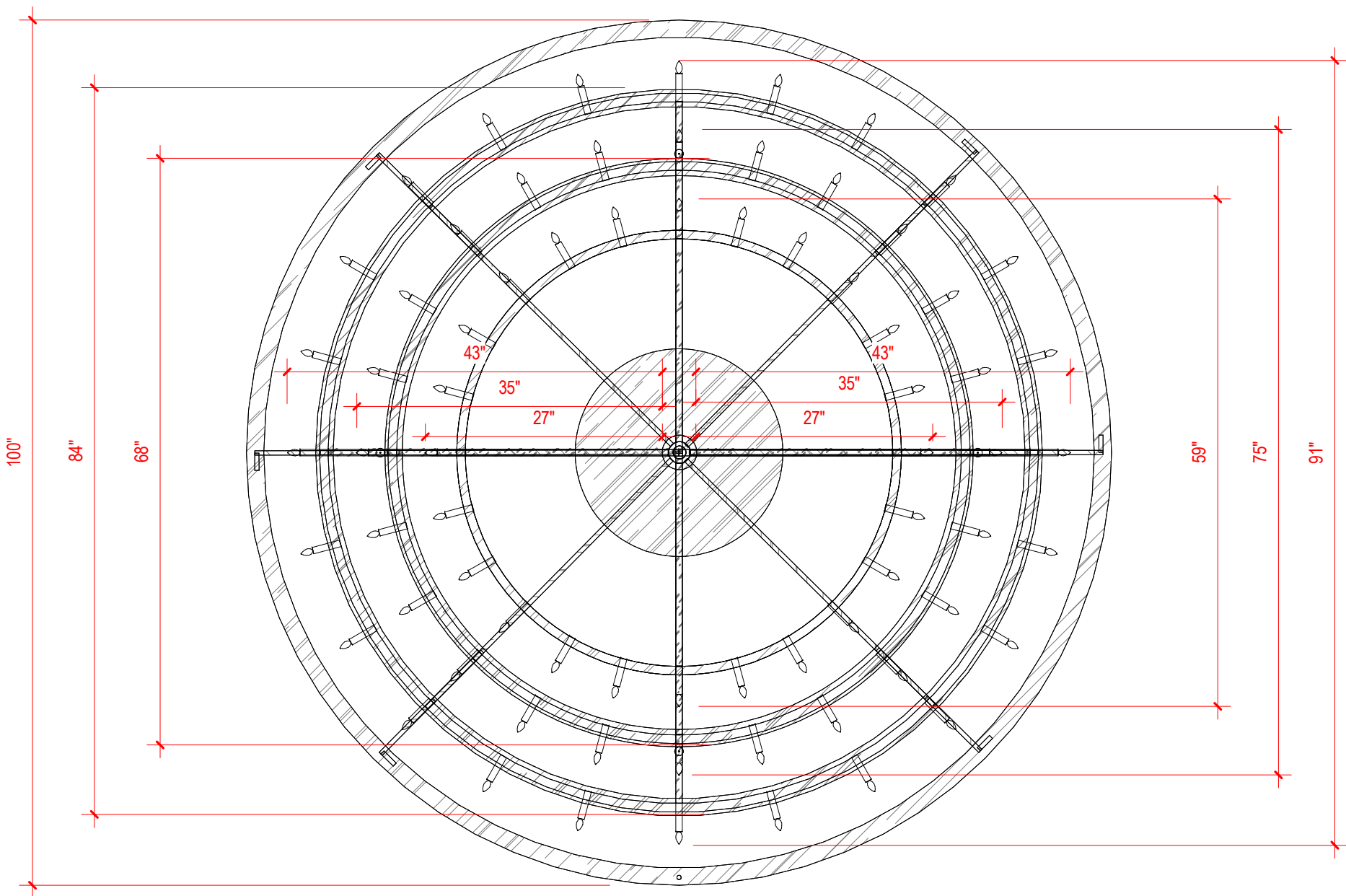

1 CHANDELIER (CH-03) INTERIOR STRUCTURE - PLAN
5401.1 SCALE: 3/4" = 1'-0"

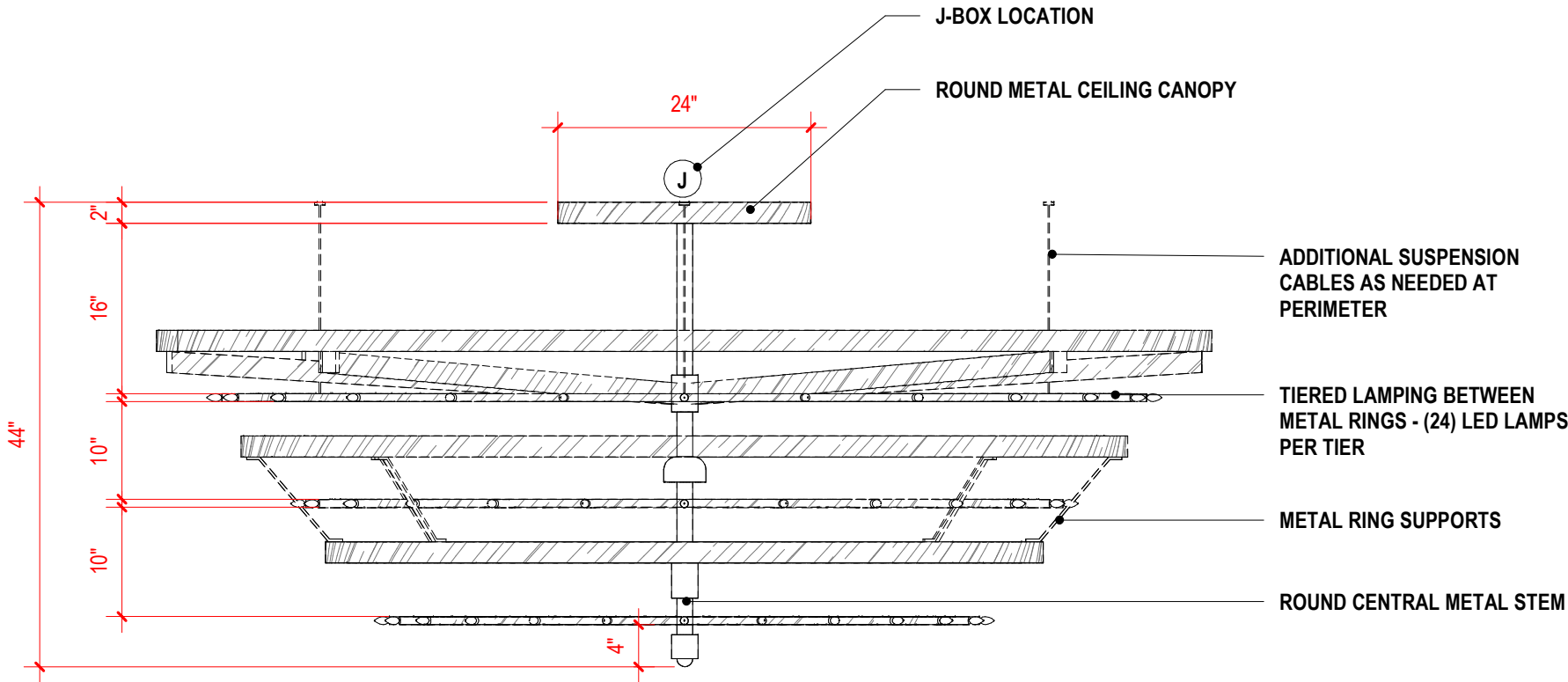

2 CHANDELIER (CH-03) INTERIOR STRUCTURE - FRONT
5401.1 SCALE: 3/4" = 1'-0"

SCALE: 3/4" = 1'-0"	QUANTITY: 3	RD · JONES INTERIOR ARCHITECTURE, DESIGN, AND PROCUREMENT 729 E. PRATT STREET, STE 2000, BALTIMORE, MD 21202 TEL: 410.332.4700 FAX: 410.332.4701 www.RDJONES.com	FINISH NOTES: METAL: Painted Metal to look like Aged Brass - to match designer's sample GLASS: Clear Vertical Ribbed Glass	
ISSUE DATE: 04/29/2025	PAGE 1 OF 2			
REVISION 1:	PROJECT NO.: 3508			
REVISION 2:	PROJECT NAME: DOUBLETREE - CENTER CITY		Lamping: (72) 5W E12 Candelabra LED, 120V, 2700K - Vendor to Provide	
REVISION 3:	LOCATION: PHILADELPHIA, PA		DRAWING TITLE: Chandelier at Ormandy Ballroom - Level 1	SPEC #: 5401

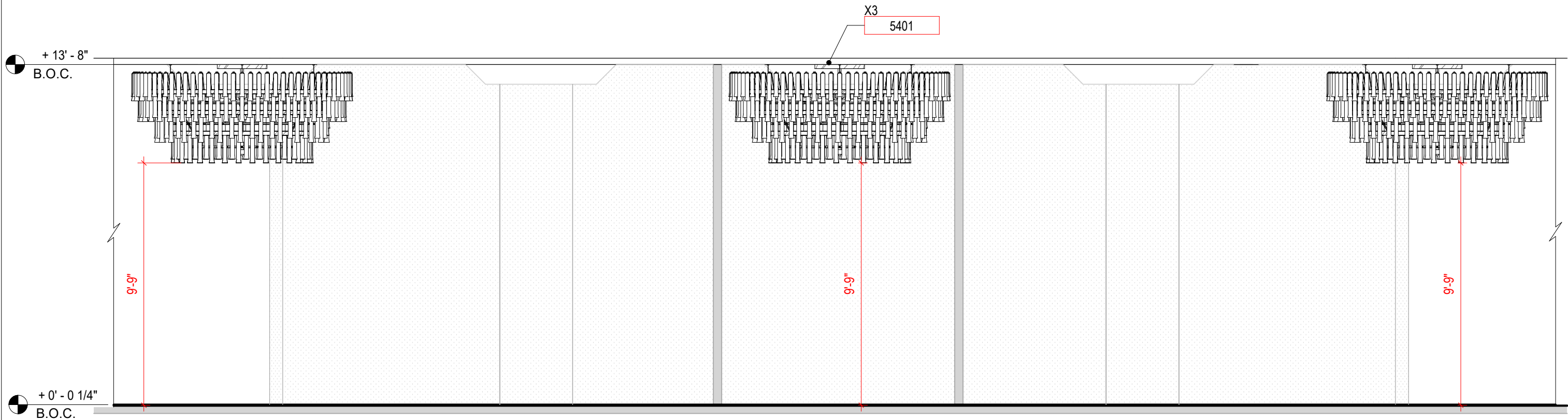

1
5401

DECORATIVE LIGHTING ELEVATION
5401 - CHANDELIER (CH-03)
SCALE: 1/4" = 1'-0"

SCALE: 1/4" = 1'-0"	QUANTITY: 3	<div>RD JONES</div> <div>INTERIOR DESIGN + ARCHITECTURE</div> <div>400 E. PRATT STREET, STE 902, BALTIMORE, MD 21202</div> <div>TEL: 410.332.4700 FAX: 410.332.4701</div> <div>www.RDJONES.com</div>	FINISH NOTES:	
ISSUE DATE: 03.28.2025	PAGE 2 OF 2			
REVISION 1:	PROJECT NO.: 3508			
REVISION 2:	PROJECT NAME: 3508 DoubleTree Center City			
REVISION 3:	LOCATION: 237 S Broad St, Philadelphia, PA 19107	DRAWING TITLE: Chandelier at Ormandy Ballroom - Level 1		SPEC #: 5401



NOTES:

- 1)METAL:ALL EXPOSED METAL FINISH TO BE AGED BRASS TO MATCH DESIGNER SAMPLE
 - 2)SHADE: CLEAR TEXTURED GLASS.
 - 3)LAMPING:INTEGRATED LED 6W 2700K.NON DIMMABLE.W/DRIVER@J-BOX, 120V.A.C.60Hz
 - 4)HARD WIRED. SUITABLE FOR INDOOR(DRY)LOCATION USE
- UL/CUL APPROVED
 ***APPROX MAX. WEIGHTS: 8LBS

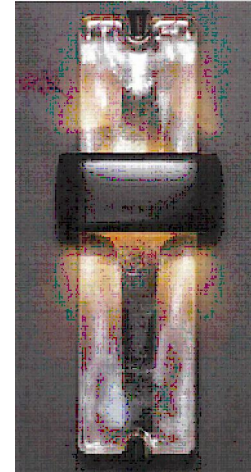
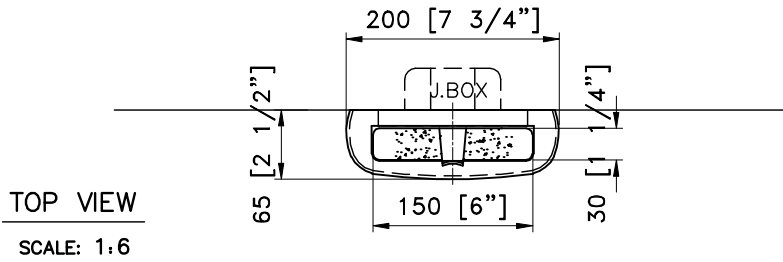

INSPIRATION
IMAGE

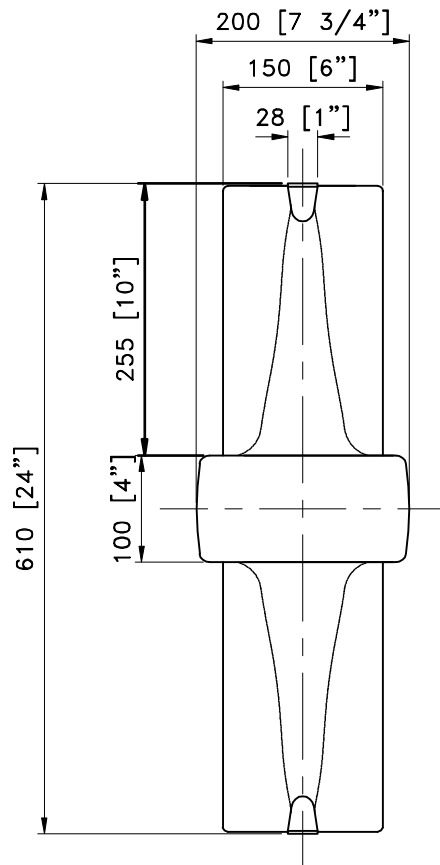

FRONT VIEW

SCALE: 1:6

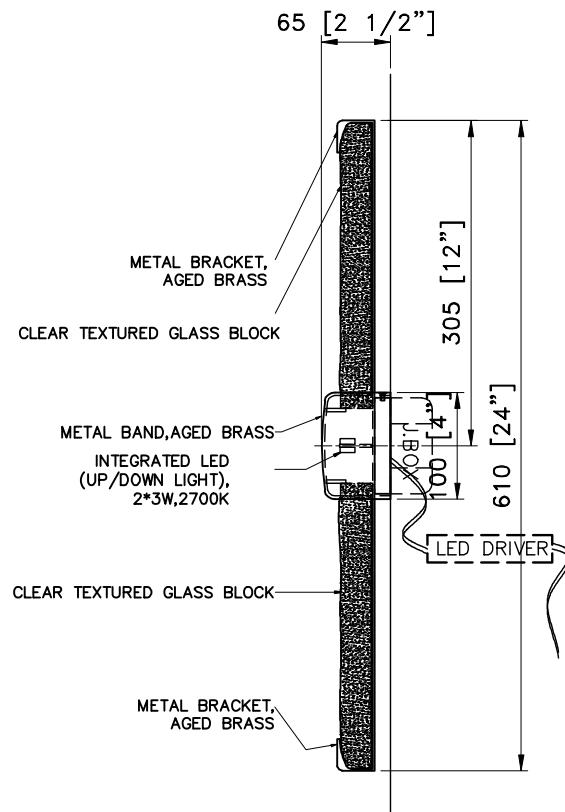

SIDE VIEW

SCALE: 1:6

CUSTOM WALL SCONCE@ AUTO LOBBY ITEM NO:LT-1401 QTY: 2 PCS		DOUBLETREE —CENTER CITY PHILADELPHIA, PA	
Approval: <input type="checkbox"/> _____ With comments: _____ _____ Signed By: _____ Estimated Leads time are contingent upon receiving approved submittals and are subject to change		Les Industries CENTURY Industries Inc. 5645 Royalmount Ave. Dwg.# Montreal,Quebec,Canada H4P 2P9 Tel: 514-842-3933 Fax: 514-842-7481 Toll free Canada only: 1-877-842-3934 Date: 2025/08/01 Rev: _____ (yyyy/mm/dd) (yyyy/mm/dd)	
		P 1/1	





NOTES:

- 1)METAL:ALL EXPOSED METAL FINISH TO BE DARK BRONZE TO MEET DESIGNER'S SAMPLE
- 2)SHADE:CLEAR TEXTURED GLASS BLOCKS.
- 3)LAMPING:INTEGRATED LED 10W 2700K. DIMMABLE.
W/DRIVER@CANOPY,,120V.A.C 60Hz
- 4)HARD WIRED. SUITABLE FOR INDOOR(DRY)LOCATION USE
UL/CUL APPROVED
- ***APPROX MAX. WEIGHTS: 8LBS

TOP VIEW

SCALE: 1:5

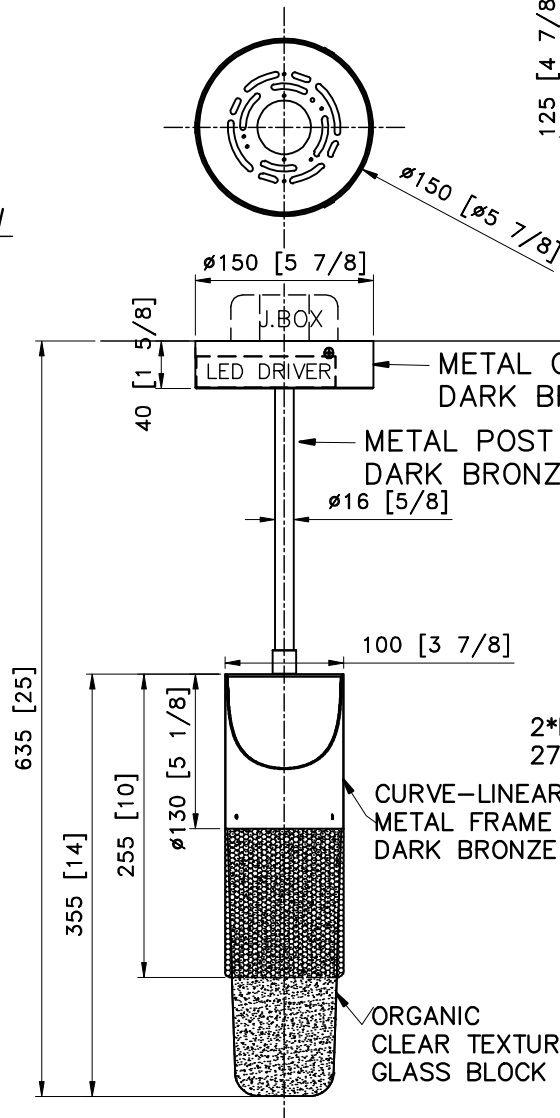

FRONT VIEW

SCALE: 1:5

TOP VIEW

SCALE: 1:5

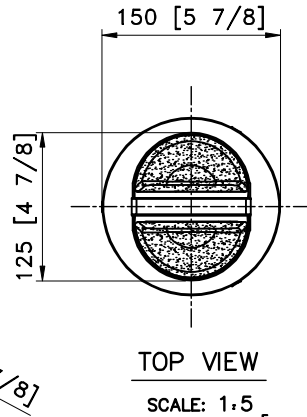

3D VIEW

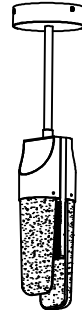

LED DRIVER

METAL CANOPY
DARK BRONZE

METAL POST
DARK BRONZE
ø16 [5/8]

100 [3 7/8]

CURVE-LINEAR
METAL FRAME
DARK BRONZE

ORGANIC
CLEAR TEXTURED
GLASS BLOCK

2*LED DC 5W
2700K

SIDE VIEW

SCALE: 1:5

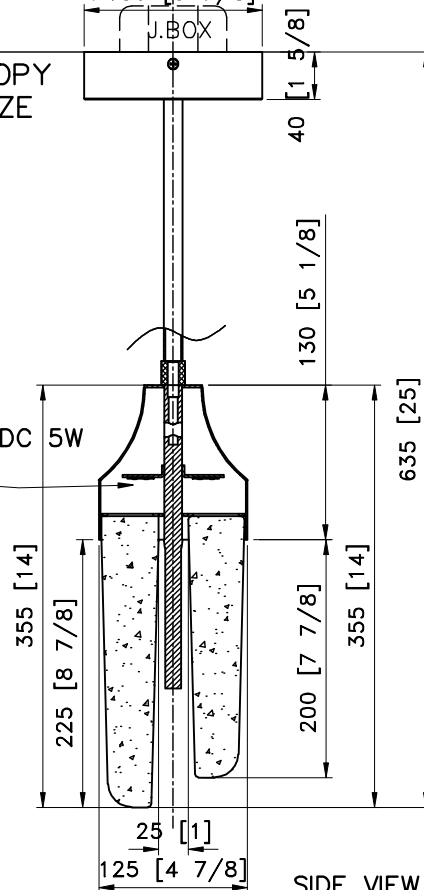

CUSTOM PENDANT LIGHT @ BAR

ITEM NO:LT-2403 QTY: 8 PCS

Approval: ☐ _____

With comments: _____

Signed By: _____

Estimated Leads time are contingent upon receiving
approved submittals and are subject to change

DOUBLETREE - CENTER CITY
PHILADELPHIA, PA

Les Industries CENTURY Industries Inc.
5645 Royalmount Ave. Dwg.#
Montreal, Quebec, Canada H4P 2P9
Tel: 514-842-3933 Fax: 514-842-7481
Toll free Canada only: 1-877-842-3934

Date: 2025/08/01 Rev: _____
(yyyy/mm/dd) (yyyy/mm/dd)

P1/1



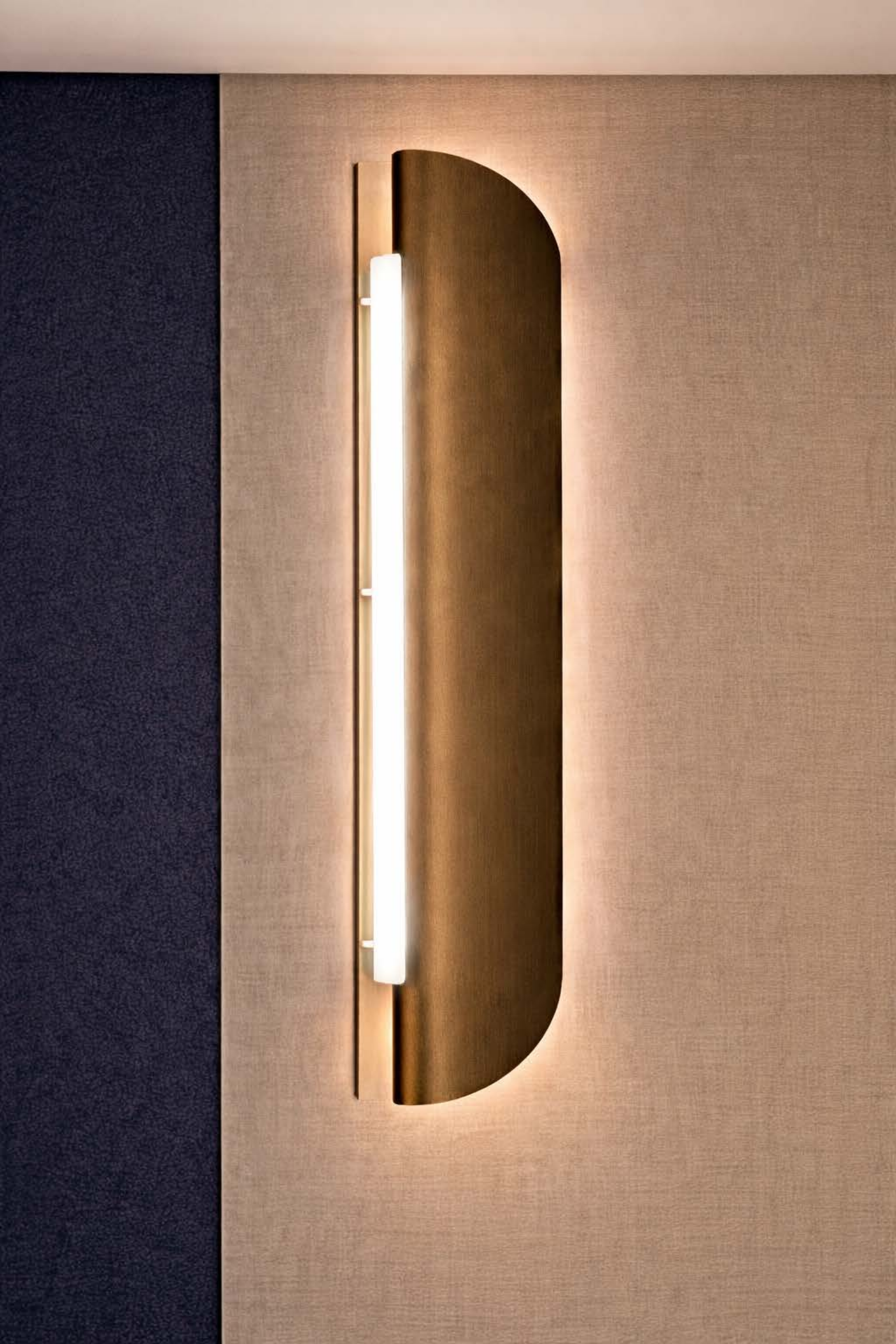

NOTES:

- 1)METAL: ALL EXPOSED METAL FINISH TO BE AGED BRASS TO MATCH DESIGNER'S SAMPLE
 - 2)SHADE:FROSTED WHITE ACRYLIC.
 - 3)LAMPING:INTEGRATED LED 18W 2700K.DIMMABLE. DRIVERLESS,120V.A.C.60Hz
 - 4)HARD WIRED. SUITABLE FOR INDOOR(DRY)LOCATION USE
- UL/CUL APPROVED
 ***APPROX MAX. WEIGHTS: 8LBS

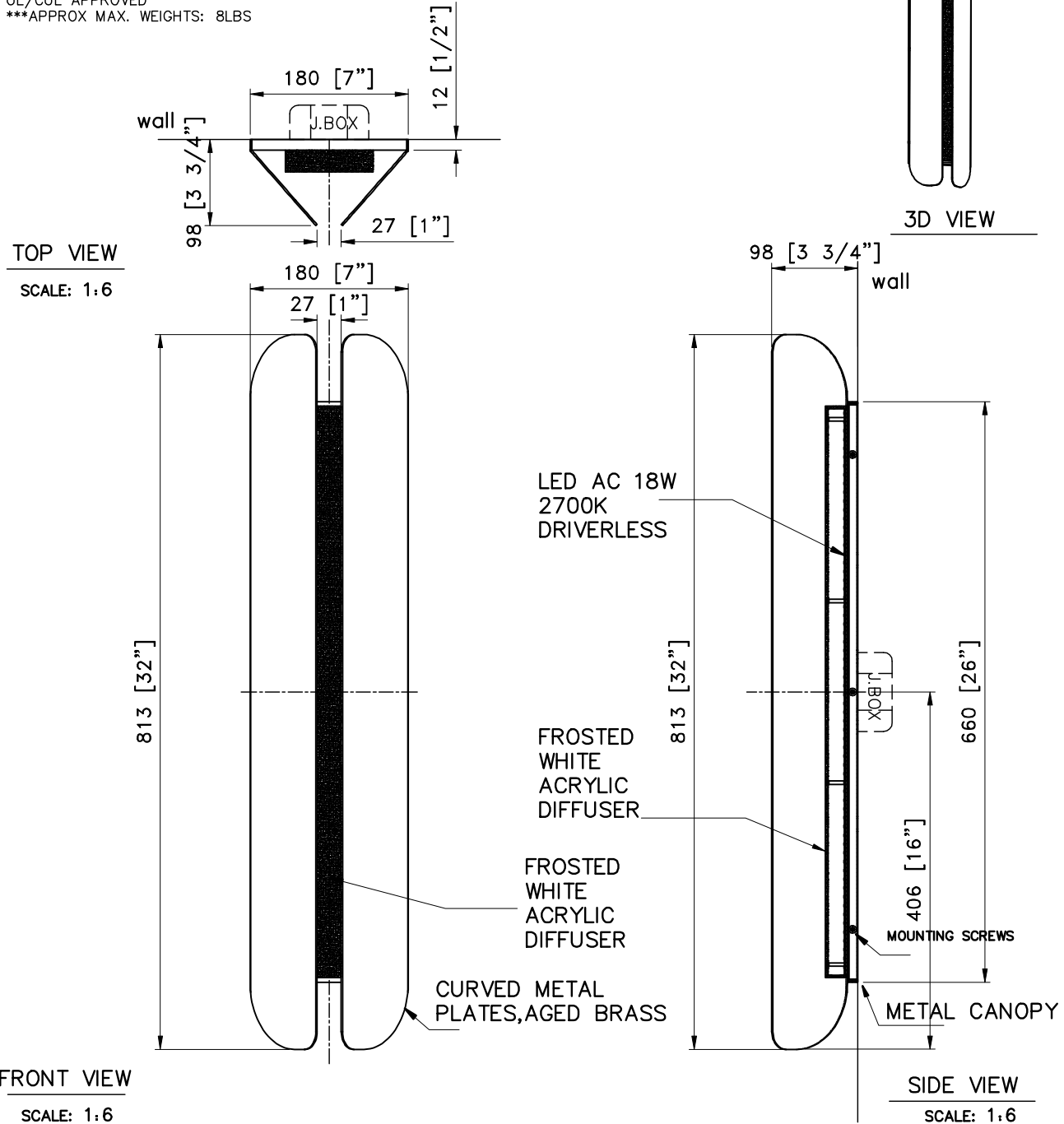

CUSTOM WALL SCENCE @ OVERATURE – LEVEL 3

ITEM NO:LT-4402 QTY: 4 PCS

DOUBLETREE –CENTER CITY
 PHILADELPHIA, PA

Approval: ☐ _____

With comments: _____

Signed By: _____

Estimated Leads time are contingent upon receiving approved submittals and are subject to change

Les Industries CENTURY Industries Inc.
 5645 Royalmount Ave. Dwg.#

Montreal, Quebec, Canada H4P 2P9

Tel: 514-842-3933 Fax: 514-842-7481

Toll free Canada only: 1-877-842-3934

Date: 2025/08/01 Rev: _____

(yyyy/mm/dd)

(yyyy/mm/dd)

P1/1



NOTES:

- 1)METAL: ALL EXPOSED METAL FINISH TO BE AGED BRASS TO MATCH DESIGNER SAMPLE
 - 2)SHADE: GLOSSY WHITE ACRYLIC@EXTERIOR+SANDBLASTED@INTERIOR.
 - 3)SOCKETS: 26xEDISON BASE MED.,120V.A.C 60Hz.COMPATIBLE
W/E26 A19 MAX.9W EA LED 3000K.DIMMABLE.BULB NOT INCLUDED
 - 4)HARD WIRED. SUITABLE FOR INDOOR(DRY)LOCATION USE
ON-SITE ASSEMBLY REQUIRED
- UL/CUL APPROVED
***APPROX MAX. WEIGHTS: 125LBS



3D VIEW

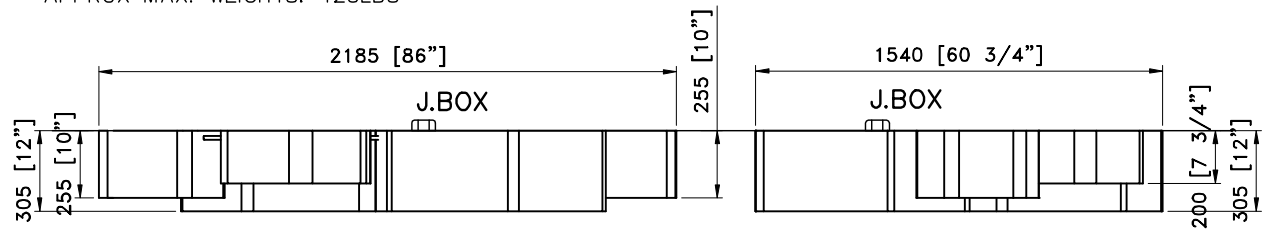

FRONT VIEW

SCALE: 1:24

SIDE VIEW

SCALE: 1:24

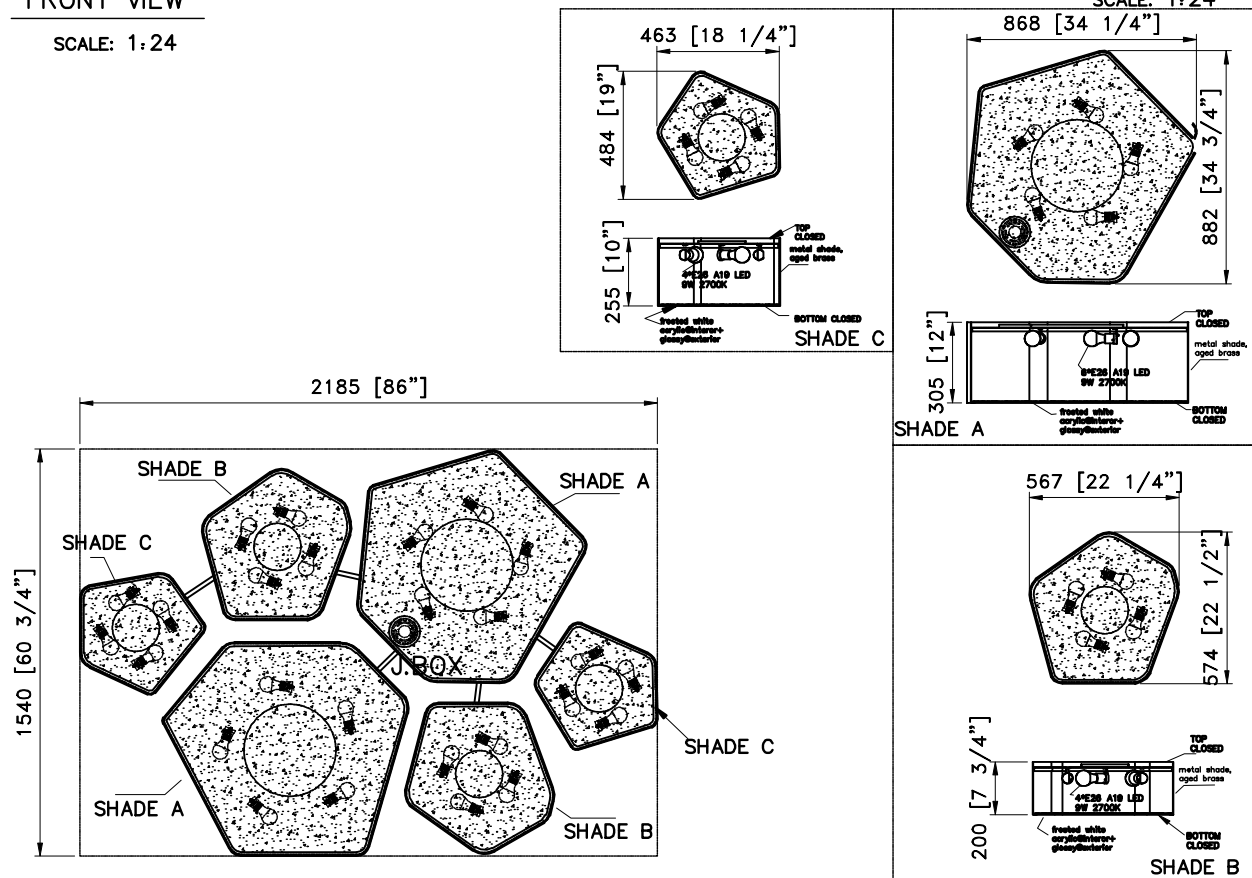

BOTTOM VIEW

SCALE: 1:24

CUSTOM DECORATIVE LIGHT FIXTURE @ RECEPTION

ITEM NO: LT-1406 QTY: 1 LOT

Approval: ☐ _____

With comments: _____

Signed By: _____

Estimated Leads time are contingent upon receiving approved submittals and are subject to change

DOUBLETREE — CENTER CITY
PHILADELPHIA, PA

Les Industries CENTURY Industries Inc.
5645 Royalmount Ave. Dwg.#
Montreal, Quebec, Canada H4P 2P9
Tel: 514-842-3933 Fax: 514-842-7481
Toll free Canada only: 1-877-842-3934
Date: 2025/08/01 Rev: _____
(yyyy/mm/dd) (yyyy/mm/dd)

P1/1